

# DHF

## Applications

Secondary filtration, safety filtration. The disk filter allows high efficiency and filtration precision.

## Materials

- Body: polyamide reinforced with fibre glass
- Cover: polyamide reinforced with fibre glass
- Closure element: stainless steel ring AISI 304
- Filtering element:
  - mesh in stainless steel AISI 304 with polypropylene structure
  - mesh in polyester with structures in stainless steel AISI 304
  - polypropylene disks
- Gaskets: NBR



## Characteristics

- Maximum working pressure: 10 bar at 20°
- Standard filtration grade: 120 mesh (filtration available: 50, 80, 120, 150, 200 mesh)
- Types of connection: threaded, victaulic or flanged
- Manometer coupling: Ø1/4" female
- Installation: on line

## Load loss\*

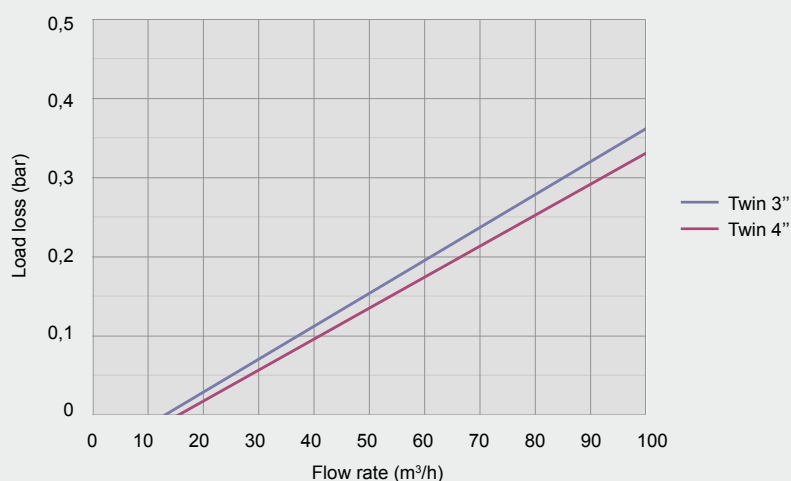

\*Testing for load loss was carried out with clean water.

# DHF

## Technical data

Couplings	Pricelist ref.	Filtering cartridge	Connections	Rec. max. flow rate (m³/h)	Filtration area (cm²)
3"	IFDHFILM2F0N	s.s.	threaded	50	2804
	IFDHFIDL2F0N	disk			
	IFDHFIELM2F0N	Rotodisk™			
	IFDHFILW0F0N	s.s.	victaulic		
	IFDHFIDLW0F0N	disk			
DN 80	IFDHFIELW0F0N	Rotodisk™	flanged		
	IFDHFILF0F0N	s.s.			
	IFDHFIDLF0F0N	disk			
	IFDHFIELF0F0N	Rotodisk™			

## Dimensions

Ø (inches)	L (mm)	A (mm)	H (mm)	Weight (kg)
3"	1020	250	330	14,40
DN 80	1020	250	330	15,20

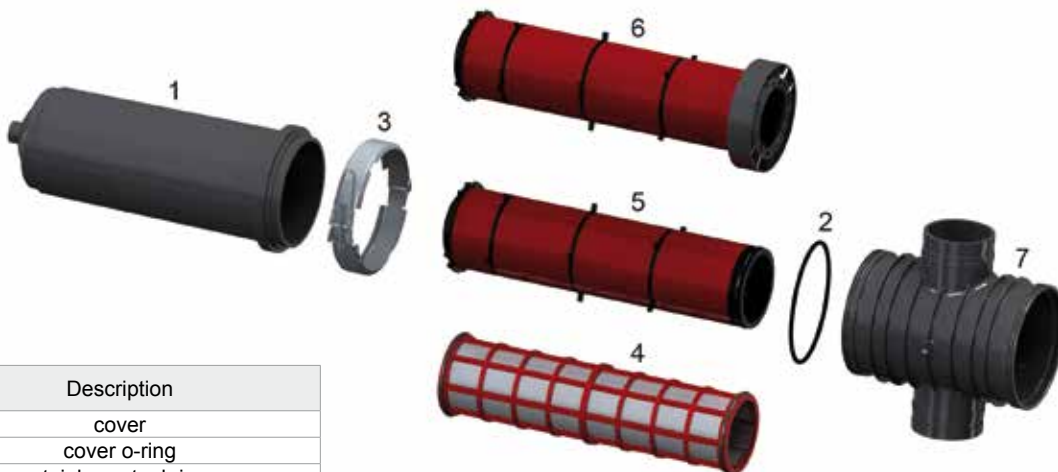
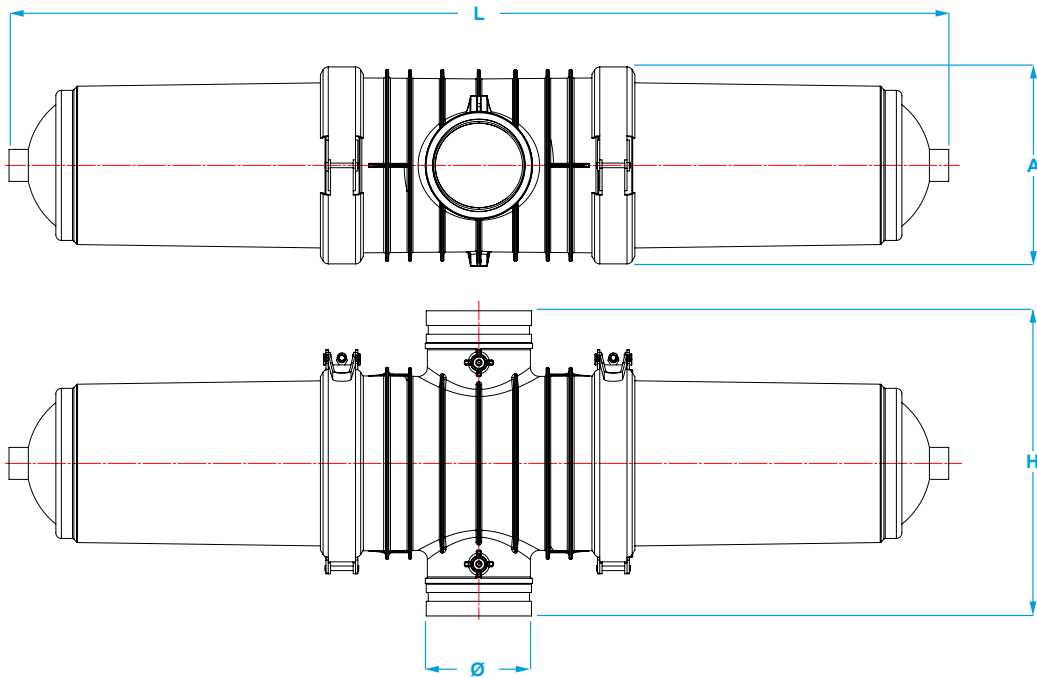

## Components

Number	Description
1	cover
2	cover o-ring
3	stainless steel ring
4	complete stainless steel screen cartridge
5	complete stainless steel disk cartridge
6	Rotodisk® cartridge (with deflector)
7	twin filter body